

LID OPENING



Unplug power supply
before any maintenance.



Unclip the lid by levering each
tank lateral clip with a flat
screwdriver.



Pull up the lid.



Unclip the cable sheath
by pressing it with the thumb.

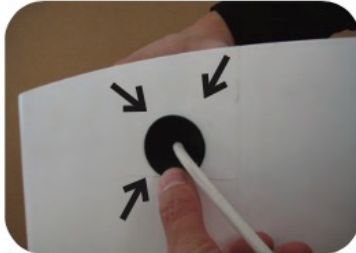

Pull out the motor block.



BASKET & CUTTER REMOVAL

Unclip
the bakset
lid by a
simple rotation
thanks to a flat
screwdriver.



With the flat
screwdriver
unclip the
basket from
the motor
cover's hooks.



Thanks to a
flat pinch,
unclip the
circlip of the
cutter.

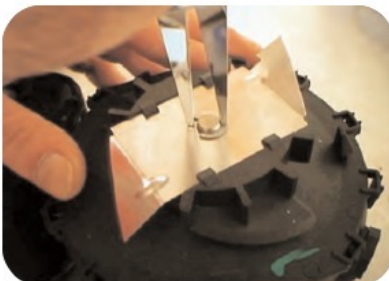

Lever the
cutter and its
support thanks
to 2 screw
drivers.

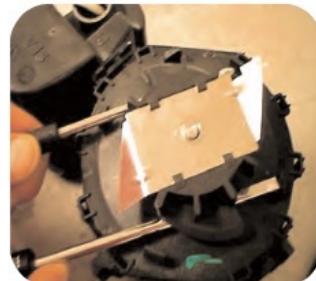

PRESSURE CHAMBER DISMOUNTING

Work with the motor
positionned upside down
(cutter down).



Unclip the membrane
half-clips with
a flat screwdriver.



Put off the membrane.



Unclip both sides of the
pressure chamber base
with a flat.



Pull it with the electrical
equipment.



Verify the correct connections
of the wires
in the junction block.

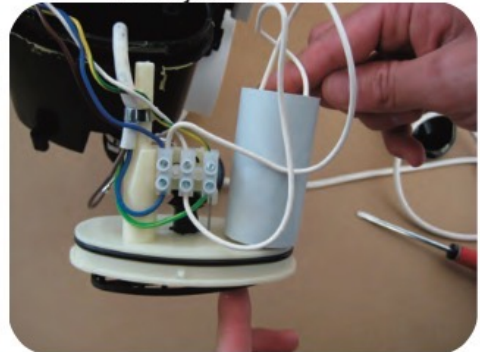

Verify the correct clipping of the switch.

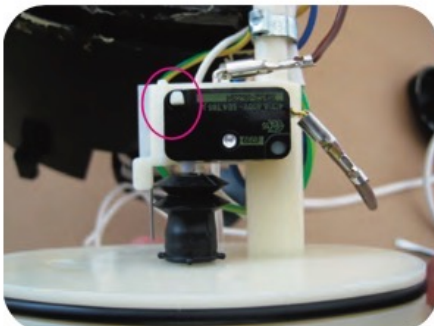

Verify the correct position of the grille:
good not good



PRESSURE CHAMBER REMOUNTING

Unclip the cable sheath metalclip with a flat.



Insert the electric equipment back (beware not to squeeze the cables).



Put back the black rubber round gasket.



Use a simple rod to guide the position of the gasket: the free hole should correspond to the chimney / vent below.



Remount the cable sheath and its metal clip.



Tight the metal clip with an adapted pinch.



Remount the membrane (beware to respect the lateral guide).



Position the 2 half-clips **BETWEEN** the membrane and the pressure chamber.



Respect the correct mounting side (chamfer).



Click back the 2 half-clips with a pinch.



Press the membrane to check the free movement and correct switch clicking/ activation.



PUMP CHAMBER & IMPELLER

Unclip the discharge elbow from the pump chamber.



Unclip the pump body by rotating clockwise.



Verify that the small hole of the pressure chamber is not blocked.



By maintaining the cutter (BEWARE!) unscrew the impeller anti-clockwise. Take out the washer.



Verify that nothing is jammed in the axis / in the impeller.



Screw back the impeller with washer and remount the pump body (respect the mistake-proofing).



Clip back the discharge elbow thanks to its clip.



REMOUNTING THE PUMP

Insert the motor block in the tank
(follow the tank guides).



Reconnect the cable sheath
carefully to the tank.



Remount the cover on the lid. Beware to
the correspondance of the discharge
pipes (upper and lower parts).

Verify the correct
position of the lid gasket.



*NB : you can use dishwashing soap
to ease the closing of the lid.
BEWARE: NO GREASE.*

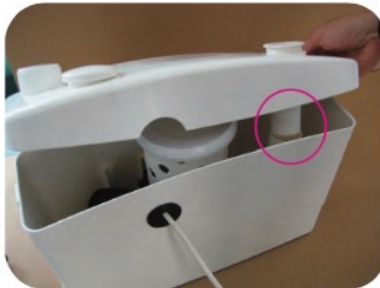

Verify that the upper
discharge pipe
is not pinched.



Push back the discharge elbow
COMPLETELY and secure the
assembly with a screw clamp.



Eventually change the
charbon filter.



Opening/closing of the
lateral plugs (1/4 turn).

